

OPERATION

The SLB Series is designed to protect three-phase equipment against **Phase Unbalance, Phase Loss, and Phase Reversal** conditions.

With normal operating voltages in the proper ABC sequence and the 120 VAC control voltage applied, the internal relay will energize (PICK-UP). When any combination of Phase Unbalance exceeding the preset value or Phase Loss or Phase Reversal occurs for longer than the preset drop out time, the output relay will de-energize (DROP-OUT). If the control voltage is removed, the relay will de-energize.

The wide input voltage range permits use on any one of several standard line voltages without recalibrating. The unbalance detection level is adjustable from 2% to 15%.

Both Delta and Wye systems may be monitored. In Wye systems, connections to neutral are not required.

The LED indicator glows when conditions are normal.

NOTE: A balanced condition exists and the output relay will energize when there is a complete absence of voltage on all three phases (Terminals 1, 3 and 5) and the control voltage is continuously applied to (Terminals 11 and 12). For this reason, the SLB series is ideally suited for load side monitoring applications.



Phase Unbalance Monitor

SPECIFICATIONS

OUTPUT RATING	SPDT, 10 Amps @ 120 VAC, 5 Amps @ 240 VAC, Resistive	
PHASE SEQUENCE	ABC (Will Not Operate CBA)	
OPERATING VOLTAGE	See Table Below	
CONTROL VOLTAGE	120 VAC, 1 Phase, 60 Hz	
POWER REQUIRED	3 VA, Max.	
PHASE UNBALANCE RANGE	2% to 15%, Adjustable	
INDICATORS LED	Glowes When All Conditions Are Normal	
RESPONSE TIMES	Operate	60 mSEC, Fixed
	Release	0.1 to 5 SEC, Adjustable
TEMPERATURE RATING	Operate	32° to +104°F (0° to +40°C)
	Storage	-49° to 185°F (-45° to +85°C)
ENCLOSURE	Style "E" LEXAN® Surface Mount	
WEIGHT	1 lb. 2 oz.	

The SLB Series will not detect an equal and simultaneous reduction in voltage on all three lines (Brown Out).

MODEL NUMBER	OPERATING VOLTAGE	RESET	HYSTERESIS
SLB-200-ALEA	Standard 0-300; 3 Ø Line Voltages 60 Hz	Automatic	10% of Unbalance Setting
SLB-200-ALER		Manual	None
SLB-400-ALEA	Standard 300-500; 3 Ø Line Voltages 60 Hz	Automatic	10% of Unbalance Setting

All voltages referenced on this page are phase-to-phase.

DIMENSIONS (INCHES)

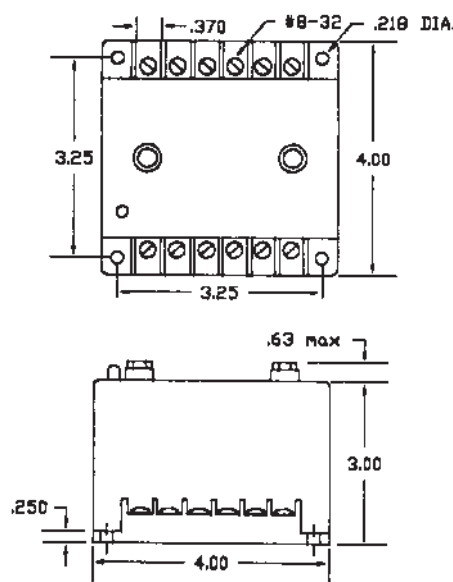

WIRING

